

Mobile Display Merchandisers

Flat Glass

DF270



DF470



Adjustable glass shelves



LED lighting

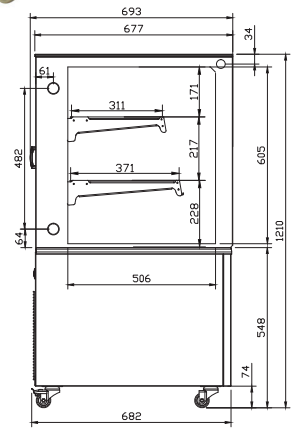
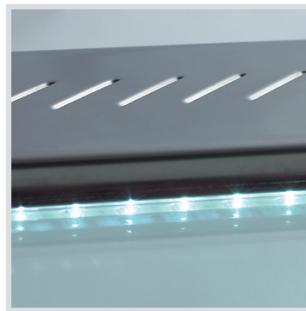

FEATURES

- Stainless steel construction
- Double glazed glass
- 2 x adjustable glass shelves
- Rear sliding doors for easy management
- LED lighting from top & underneath of each shelf
- 4 castors with 2 braked
- Suitable to be cladded or built in
- Ideal for cafes and retail outlets looking to showcase and sell fresh food

TECHNICAL SPECIFICATIONS

- Controller: Digital controller with temperature display
- Cooling: Fan assisted
- Defrost: Automatic
- Refrigerant: R290
- Climate Class: 3
- Temperature Range: +2°C ~ +8°C
- Power Supply: 13amp

MODEL	GROSS CAPACITY	EXT. DIMENSIONS (H x W x D mm)	ENERGY RATING	POWER CONSUMPTION	KWH /ANNUM	DECIBELS	WEIGHT (kg)	RRP
DF270	295L	1210 x 915 x 693	C	480W	2702	55dBA	154	£2,109.00
DF370	400L	1210 x 1215 x 693	C	490W	3157	55dBA	188	£2,553.00
DF470	500L	1210 x 1515 x 693	C	490W	2700	55dBA	230	£3,013.00

