

HBC2/3/4CRXX

Exploded parts diagram

Image shown is HBC4CRXX With Upstand

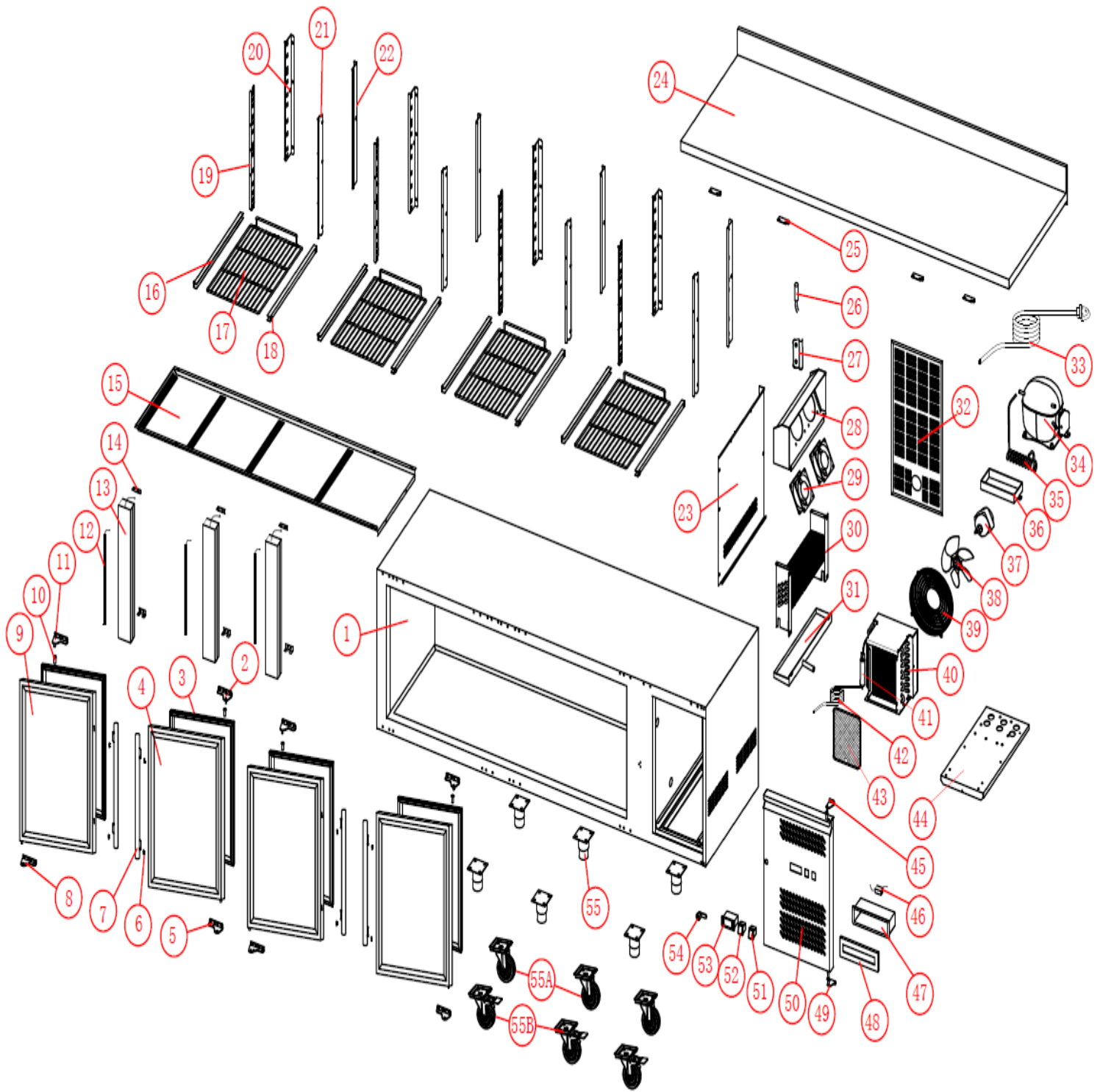





Part Number	Number	Description	Qty
***	1	Cabinet	1
X1-HINGE13	2	RH Upper Hinge (HBC4CRXX)	2
X1-HINGE13	2	RH Upper Hinge (HBC3CRXX)	2
X1-HINGE13	2	RH Upper Hinge (HBC2CRXX)	1
***	3	Door Gasket (HBC4CR4XX)	4
***	3	Door Gasket (HBC3CRXX)	3
***	3	Door Gasket (HBC2CRXX)	2
***	4	Glass Door (right) (HBC4CRXX)	3
***	4	Glass Door (right) (HBC3CRXX)	2
***	4	Glass Door (right) (HBC2CRXX)	1
X1-HINGE14	5	RH Bottom Hinge (HBC4CRXX)	2
X1-HINGE14	5	RH Bottom Hinge (HBC3CRXX)	2
X1-HINGE14	5	RH Bottom Hinge (HBC2CRXX)	1
***	6	Glass Door Handle Screw (HBC4CRXX)	16
***	6	Glass Door Handle Screw (HBC3CRXX)	12
***	6	Glass Door Handle Screw (HBC2CRXX)	8
***	7	Handle (HBC4CRXX)	4
***	7	Handle (HBC3CRXX)	3
***	7	Handle (HBC2CRXX)	2
X1-HINGE15	8	LH Bottom Hinge (HBC4CRXX)	2
X1-HINGE15	8	LH Bottom Hinge (HBC3CRXX)	1
X1-HINGE15	8	LH Bottom Hinge (HBC2CRXX)	1
***	9	Glass Door (left) (HBC4CRXX)	2
***	9	Glass Door (left) (HBC3CRXX)	1
***	9	Glass Door (left) (HBC2CRXX)	1
K8-AXISSLEEVE	10	Door Bush (HBC4CRXX)	8
K8-AXISSLEEVE	10	Door Bush (HBC3CRXX)	6
K8-AXISSLEEVE	10	Door Bush (HBC2CRXX)	4
X1-HINGE16	11	LH Upper Hinge (HBC4CRXX)	2
X1-HINGE16	11	LH Upper Hinge (HBC3CRXX)	2
X1-HINGE16	11	LH Upper Hinge (HBC2CRXX)	1
***	12	LED (HBC4CRXX)	3
***	12	LED (HBC3CRXX)	2
***	12	LED (HBC2CRXX)	1
***	13	Mullion (HBC4CRXX)	3
***	13	Mullion (HBC3CRXX)	2
***	13	Mullion (HBC2CRXX)	1
***	14	Mullion Connection (HBC4CRXX)	6
***	14	Mullion Connection (HBC3CRXX)	4
***	14	Mullion Connection (HBC2CRXX)	2
***	15	Air Distribution Panel	1
K8-GUIDE02	16	Left Shelf Guide (HBC4CRXX)	4

K8-GUIDE02	16	Left Shelf Guide (HBC3CRXX)	3
K8-GUIDE02	16	Left Shelf Guide (HBC2CRXX)	2
X1-SHELF04	17	Shelf (HBC4CRXX)	4
X1-SHELF04	17	Shelf (HBC3CRXX)	3
X1-SHELF04	17	Shelf (HBC2CRXX)	2
K8-GUIDE03	18	Right Shelf Guide (HBC4CRXX)	4
K8-GUIDE03	18	Right Shelf Guide (HBC3CRXX)	3
K8-GUIDE03	18	Right Shelf Guide (HBC2CRXX)	2
***	19	Ladder Rack (left) (HBC4CRXX)	4
***	19	Ladder Rack (left) (HBC3CRXX)	3
***	19	Ladder Rack (left) (HBC2CRXX)	2
***	20	Rear Ladder Rack (left) (HBC4CRXX)	4
***	20	Rear Ladder Rack (left) (HBC3CRXX)	3
***	20	Rear Ladder Rack (left) (HBC2CRXX)	2
***	21	Ladder Rack (right) (HBC4CRXX)	4
***	21	Ladder Rack (right) (HBC3CRXX)	3
***	21	Ladder Rack (right) (HBC2CRXX)	2
***	22	Rear Ladder Rack (right) (HBC4CRXX)	4
***	22	Rear Ladder Rack (right) (HBC3CRXX)	3
***	22	Rear Ladder Rack (right) (HBC2CRXX)	2
***	23	Evap Cover (HBC4/3/2CRXX)	1
X1-WORKTOP4U	24	Counter Top w/upstand (HBC4CRXX)	1
X1-WORKTOP3U	24	Counter Top w/upstand (HBC3CRXX)	1
X1-WORKTOP2U	24	Counter Top w/upstand (HBC2CRXX)	1
X1-WORKTOP4	24	Counter Top no upstand (HBC4CRXX)	1
X1-WORKTOP3	24	Counter Top no upstand (HBC3CRXX)	1
X1-WORKTOP2	24	Counter Top no upstand (HBC2CRXX)	1
***	25	Top Fixing Plate (HBC4CRXX)	4
***	25	Top Fixing Plate (HBC3CRXX)	4
***	25	Top Fixing Plate (HBC2CRXX)	3
K8-PROBE01	26	Air Probe (HBC4/3/2CRXX)	1
***	27	Probe Cover (HBC4/3/2CRXX)	1
***	28	Evap Fan Cover (HBC4/3/2CRXX)	1
X1-FAN03	29	Evap Fan (HBC4/3/2CRXX)	2
X1-EVAP06	30	Evaporator (HBC4/3/2CRXX)	1
***	31	Evap Drip Tray (HBC4/3/2CRXX)	1
***	32	Back Cover (HBC4/3/2CRXX)	1
***	33	Power Cord (HBC4/3/2CRXX)	1
X1-COMP05	34	Compressor (HBC4CRXX)	1
X1-COMP06	34	Compressor (HBC3/2CRXX)	1
***	35	Vaporising Coil (HBC4/3/2CRXX)	1
K8-PAN01	36	Vaporising Tray (HBC4/3/2CRXX)	1
X1-FAN01	37	Cond Fan Motor (HBC4/3/2CRXX)	1
***	38	Cond Fan Blade (HBC4/3/2CRXX)	1
***	39	Cond Fan Guard (HBC4/3/2CRXX)	1
***	40	Condenser (HBC4/3/2CRXX)	1
***	41	Drier (LBC4/3/2CRXX)	1
X1-CAPILLARY04	42	Capillary (HBC4/3/2CRXX)	1
***	43	Condenser Filter (HBC4/3/2CRXX)	1

***	44	Cooling Unit board (HBC4/3/2CRXX)	1
***	45	Control Panel Upper Hinge (HBC4/3/2CRXX)	1
***	46	LED Driver (HBC4/3/2CRXX)	1
***	47	plastic water-proof box (HBC4/3/2CRXX)	1
***	48	plastic water-proof box cover (HBC4/3/2CRXX)	1
***	49	Control Panel Bottom Hinge (HBC4/3/2CRXX)	1
***	50	Panel (HBC4/3/2CRXX)	1
***	51	Light Switch (HBC4/3/2CRXX)	1
X1-SWITCH01	52	Power Switch (HBC4/3/2CRXX)	1
X1-CONTROLLER03	53	Controller (HBC4/3/2CRXX)	1
X1-LOCK04	54	Door Lock (HBC4/3/2CRXX)	1
***	55	Feet (optional) (HBC4/3/2CRXX)	6
***	55A	Castors (Unbraked) (HBC4/3/2CRXX)	3
***	55B	Castors (Braked) (HBC4/3/2CRXX)	3

*** Please contact Spares for assistance ***